

CLASSIC DUO

- pure simplicity and unpretentious elegance are what distinguish these baths
- bathing with a friend: two identical back rests and centrally positioned waste
- classical four-cornered model
- made of KALDEWEI steel enamel



Similar illustration

To order the bath with pre-drilled grip holes on one side, please order model xxxx**1011**xxxx.

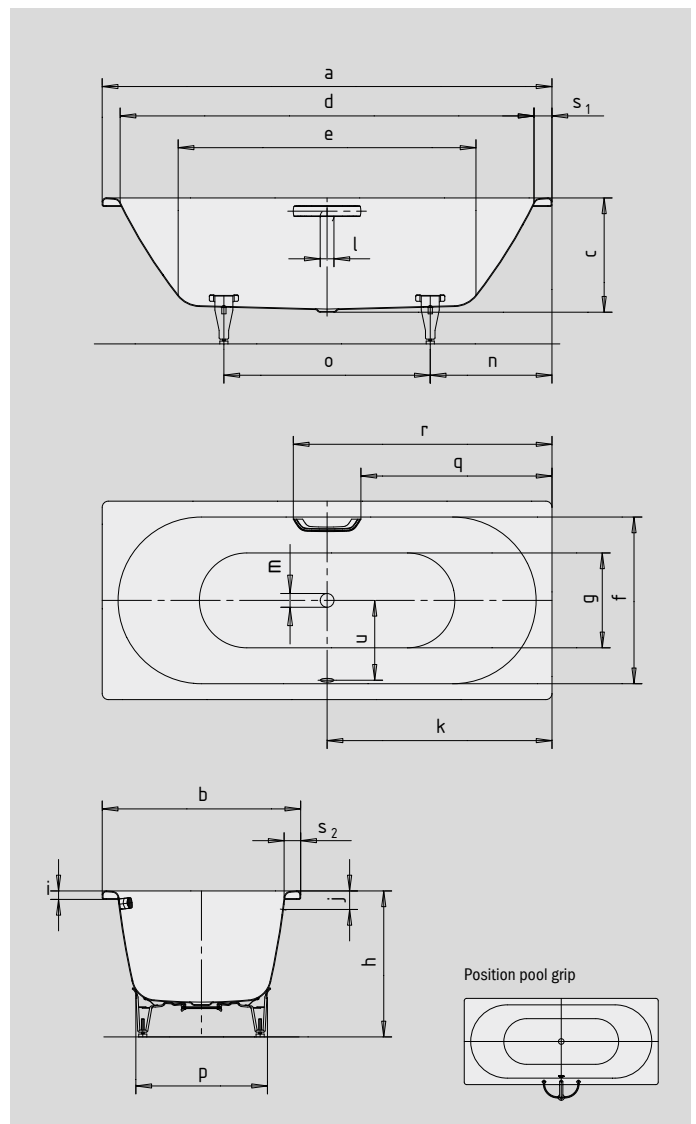

Grip DISCREET OPULENCE



| Model No. | | 103 | 105 | 107 |
|--|---------------------------------|-------------|-------------|----------------|
| External length | a | 1600 | 1700 | 1700 mm |
| External width | b | 700 | 700 | 750 mm |
| Depth | c | 430 | 430 | 430 mm |
| Internal length (top) | d | 1480 | 1580 | 1580 mm |
| Internal length (bottom) | e | 1030 | 1130 | 1130 mm |
| Internal width (top) | f | 580 | 580 | 630 mm |
| Internal width (bottom) | g | 450 | 450 | 500 mm |
| Height with feet | h | 570-605 | 565-600 | 560-595 mm |
| Height of rim | i | 32 | 32 | 32 mm |
| Distance top edge to centre of overflow hole | j | 70 | 70 | 70 mm |
| Distance bath edge to centre of drain hole | k | 800 | 850 | 850 mm |
| Diameter of overflow hole | l | 52 | 52 | 52 mm |
| Diameter of drain hole | m | 52 | 52 | 52 mm |
| Distance foot end of bath edge to centre of foot | n | 560 | 560 | 560 mm |
| Distance between the feet | o | 480 | 580 | 580 mm |
| Max. width of feet | p | 430 | 420 | 470 mm |
| Distance bath edge to where grip/handle starts | q | 672 | 722 | 722 mm |
| Distance bath edge to where grip/handle ends | r | 928 | 978 | 978 mm |
| Width of rim (foot end; lengthwise) | s ₁ ; s ₂ | 60; 60 | 60; 60 | 60; 60 mm |
| Distance between centre holes | u | 280 | 280 | 305 mm |
| Water volume** in litres | | 95 | 110 | 122 |
| Weight of the enamelled bath in kg | | 44 | 47 | 48 |
| Anti-slip | | Ø 288 | Ø 288 | Ø 435 mm |
| Full anti-slip | | 850 x 240 | 900 x 300 | 900 x 300 mm |

Note: The operational system may protrude on some whirl systems.
Please refer to the Technical Information for Whirl Systems for further information.
Subject to technical alterations, tolerances and errors. Similar illustration.
** 70 litres displacement on average.

KALDEWEI